



Construction

Single inlet, belt driven centrifugal fan with casing in cast aluminium and impeller with backward curved blades in aluminium sheet. The suspension of the belt-driven and the unique design of the casing give optimal compactness. Casing and impeller in other materials for example stainless steel or galvanized steel sheet may be supplied on request.

Motor

220-240/380-420V, 50Hz (380-420/660-690V above 3kW) three-phase or 220-240V, 50Hz single-phase asynchronous motor with capacitor. Insulation class F, enclosure IP55. Special voltage or frequency, improved enclosure IP65, 2-speed motors and explosion proof motors can be supplied on request.

Wiring diagram, see page 179.

Belt tension

Correct belt tension is very important for lifetime and the power consumption. Measure the distance between the pulleys "C" in m, calculate the necessary inward bending of the belt "f" in mm half-way between the pulleys according to the formula $f=C \times 16$. Measure the necessary force "P" that should be applied half-way between the pulleys at the right angle to achieve inward bending "f" of the belt. New belts should be tightened so that the necessary inward bend as far as possible will be equivalent to the higher tabular value P (see table). The recommended belt tension will occur within the first 15 hours.

V-belt profile	Small pulley Ø	P[N]
SPZ	67 - 95	10 - 15
SPZ	100 - 200	15 - 20
SPA	100 - 200	15 - 25

Ex.: The distance between the pulleys
 $C=0,5m$, necessary bending
 $f=0,5 \times 16=8mm$.

Technical specification

Type	Speed rpm	Motor power kW	Voltage V	Maximum current A	Maximum duty m³/h	Maximum pressure Pa	Sound level* dB(A)	Weight kg	Article number
HPBx-25-40-055S	4000	0,55	230	4,20	600	2150	81	18	113 655 050
HPBx-25-40-055T	4000	0,55	230/400Y	1,35	600	2150	81	18	113 655 055
HPBx-25-44-075S	4000	0,75	230	5,10	660	2600	82	20	113 655 060
HPBx-25-44-075T	4000	0,75	230/400Y	1,90	660	2600	82	20	113 655 065
HPBx-25-50-110S	5000	1,10	230	7,90	750	3300	83	22	113 655 070
HPBx-25-50-110T	5000	1,10	230/400Y	2,50	750	3300	83	22	113 655 075
HPBx-25-56-150S	5600	1,50	230	9,00	850	4200	84	25	113 655 080
HPBx-25-56-150T	5600	1,50	230/400Y	3,50	850	4200	84	25	113 655 085
HPBx-25-60-220T	6000	2,20	230/400Y	4,60	900	4800	84	30	113 655 090
HPBx-30-40-075S	4000	0,75	230	5,10	970	2400	82	21	113 655 100
HPBx-30-40-075T	4000	0,75	230/400Y	1,90	970	2400	82	20	113 655 105
HPBx-30-44-110S	4400	1,10	230	7,90	1070	2960	83	23	113 655 110
HPBx-30-44-110T	4400	1,10	230/400Y	2,50	1070	2950	83	22	113 655 115
HPBx-30-50-150S	5000	1,50	230	9,00	1230	3850	85	26	113 655 120
HPBx-30-50-150T	5000	1,50	230/400Y	3,50	1230	3850	85	25	113 655 125
HPBx-30-56-220T	5600	2,20	230/400Y	4,60	1400	4780	88	30	113 655 130
HPBx-30-60-300T	6000	3,00	230/400Y	6,60	1450	5450	88	33	113 655 135
HPBx-200-38-150S	3800	1,50	230	9,00	1250	4450	84	33	113 655 200
HPBx-200-38-150T	3800	1,50	230/400Y	3,40	1250	4450	84	32	113 655 205
HPBx-200-43-220T	4300	2,20	230/400Y	4,60	1400	5560	87	37	113 655 210
HPBx-200-45-300T	4500	3,00	230/400Y	6,60	1490	6150	89	39	113 655 215
HPBx-200-48-300T	4800	3,00	230/400Y	6,60	1400	7000	91	40	113 655 220
HPBx-200-51-300T	5100	3,00	230/400Y	6,60	1100	7720	93	41	113 655 225
HPBx-260-38-220T	3800	2,20	230/400Y	4,60	1400	4100	86	39	113 655 250
HPBx-260-43-300T	4300	3,00	230/400Y	6,60	1580	5150	88	41	113 655 255
HPBx-260-45-300T	4500	3,00	230/400Y	6,60	1500	5720	90	39	113 655 260
HPBx-260-48-300T	4800	3,30	230/400Y	6,60	1300	6440	92	39	113 655 265
HPBx-300-31-220T	3100	2,20	230/400Y	4,60	2360	3750	90	44	113 655 320
HPBx-300-35-300T	3500	3,00	230/400Y	6,60	2650	4740	92	46	113 655 330

* - in the middle of the performance curve.

Accessories

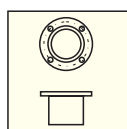

Connector
suction side
page 149

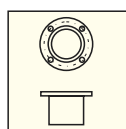

Connector
pressure side
page 149

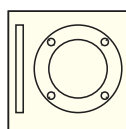

Welding flange
suction side
page 150

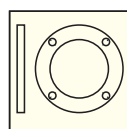

Welding flange
pressure side
page 150

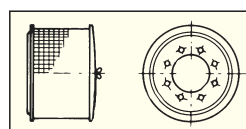

Filter
suction side
page 150

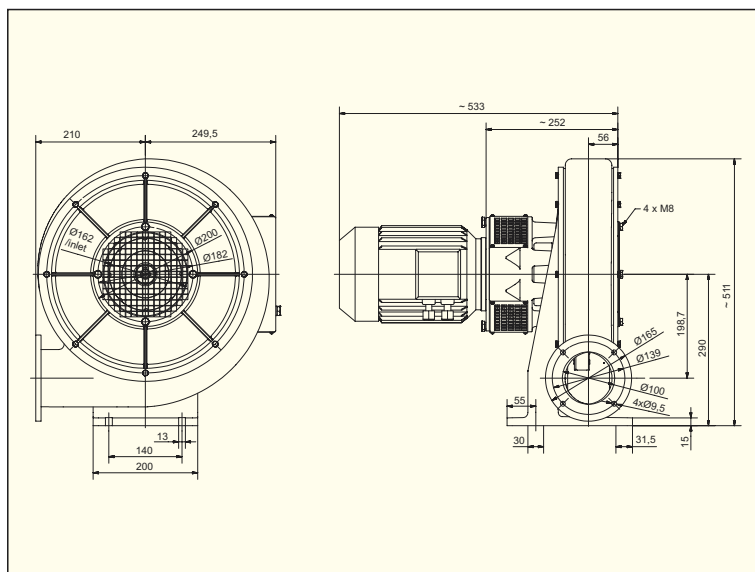
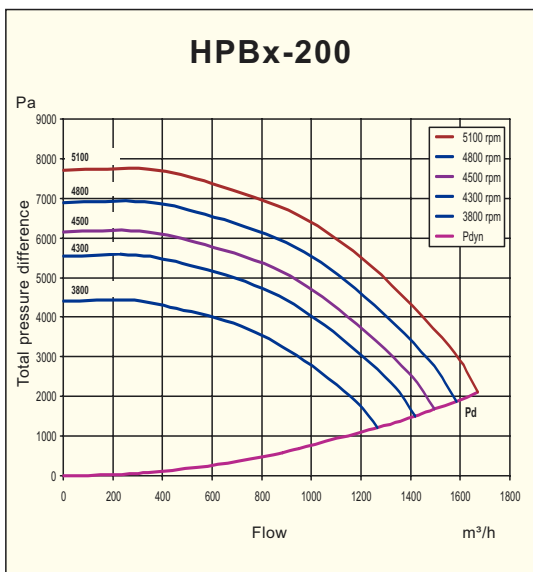
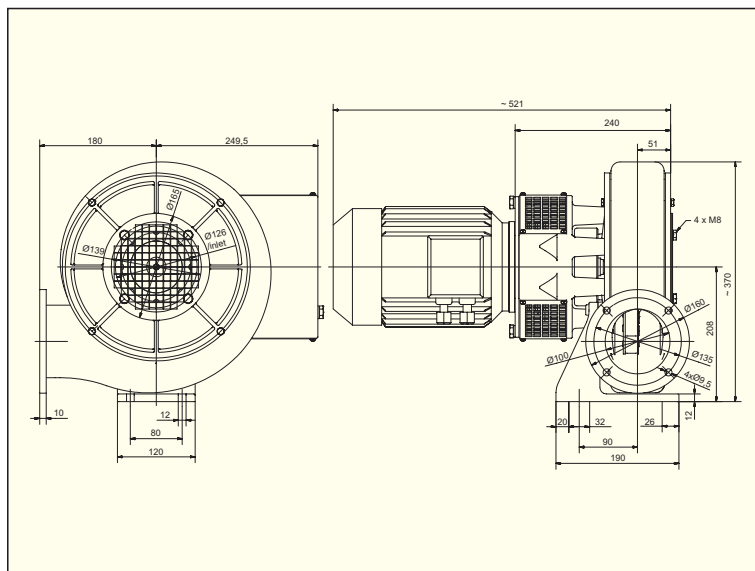
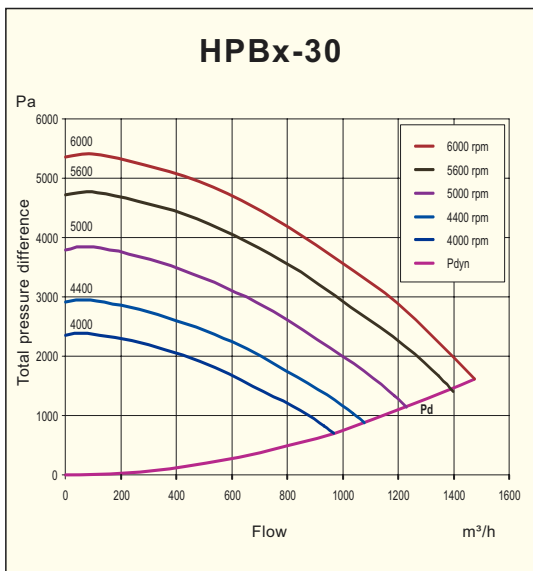
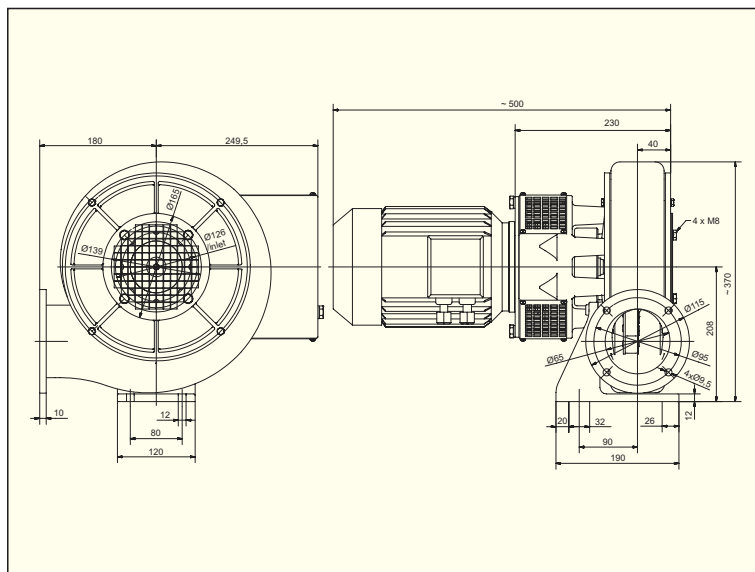
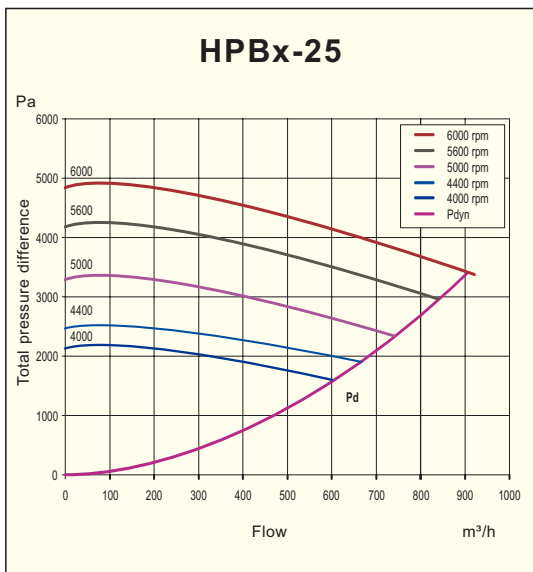

HPBx-260

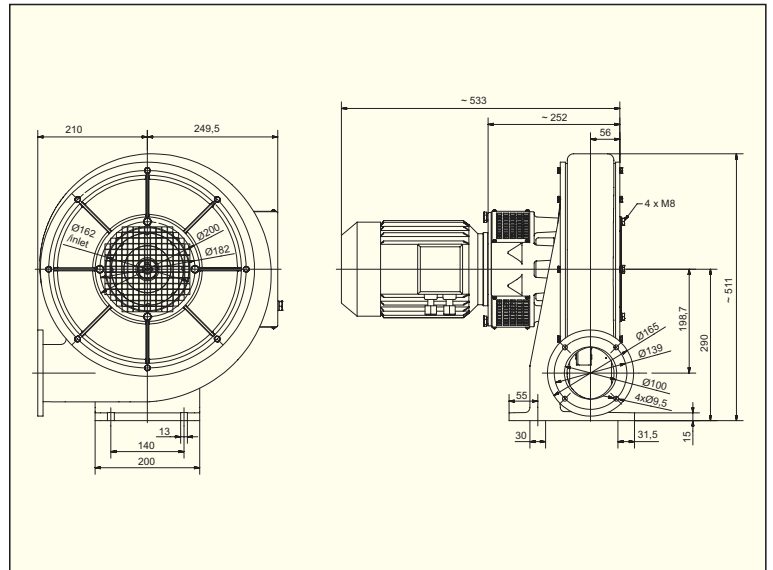
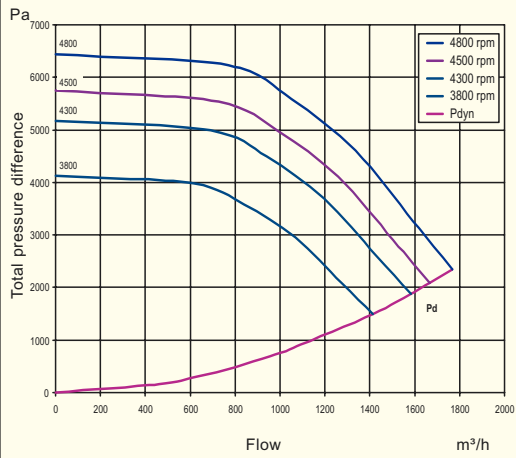

HPBx-300

